

## Front Suspension:

Reset Forms

<b>Ride Height:</b>	15mm
<b>Camber:</b>	-1
<b>Toe:</b>	1 degree out
<b>Arm Type:</b>	kit gull
<b>Tower Type:</b>	gull
<b>Caster Block Insert:</b>	+5
<b>Steering Block:</b>	kit
<b>Bulkhead Type:</b>	alu
<b>Kick-Up Angle:</b>	25
<b>Wheel Hex:</b>	5mm
<b>Notes:</b>	low mount front wing

**Anti Roll Bar:**

White (0.8mm)

Gray (0.9mm)

Blue (1.0mm)

Other:

**Bump Steer Spacing:** 0

**Axle Height:**

+3

+2

+1

0

**Ball Stud Spacing:** 1mm

**Steering Plate:** kit

**Steering Stop Spacing:** 0

**Ball Stud Spacing:** 1mm

**Caster Block Spacing:**

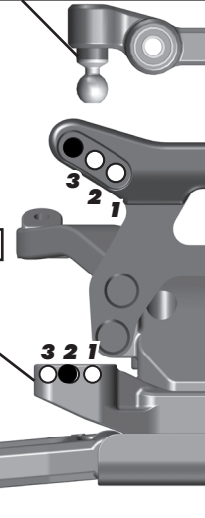
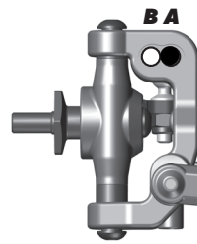
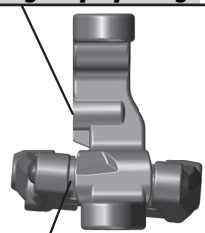
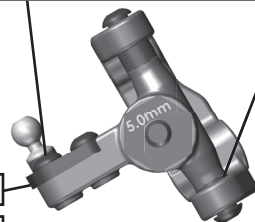

## Rear Suspension:

<b>Ride Height:</b>	15mm
<b>Camber:</b>	-1.5
<b>Tower Type:</b>	kit
<b>Wheel Hex:</b>	7mm
<b>CVA Bone Length:</b>	67mm
<b>CVA Pin Location:</b>	Inner as per kit
<b>Hub Spacing:</b>	Forward <input type="checkbox"/> Middle <input type="checkbox"/> Back <input checked="" type="checkbox"/>
<b>Shock Mounting Position:</b>	Front of Arm <input checked="" type="checkbox"/> Rear of Arm <input type="checkbox"/>
<b>Notes:</b>	

**Anti Roll Bar:**

White (1.2mm)

Gray (1.3mm)

Blue (1.4mm)

Other:

**Rear Hub Link Setting:**

Plastic Hub  Aluminum Hub  Ball Stud Spacing: \_\_\_\_\_

Up Down

**C Mount Inserts:** 1°  0.5°

Aluminum  Brass

**D Mount Inserts:** 1°  0.5°

Aluminum  Brass

**Hub Insert:**

+3  +2  +1  0

**Ball Stud Spacing:** 3mm

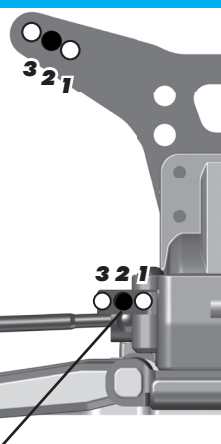
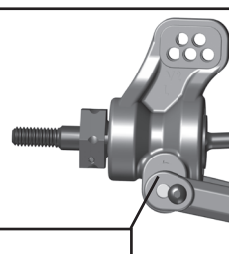
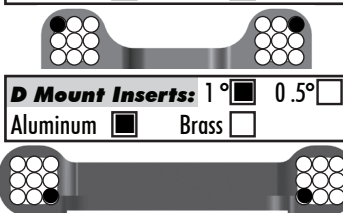

## Electronics:

<b>Radio:</b> KO Esprit IV	<b>Servo:</b> Highest DT2100
<b>EPA: Throttle:</b> 150 %	<b>Brake:</b> 150 %
<b>ESC:</b> Team Orion R10.1 Pro	
<b>ESC Settings:</b>	
<b>Motor:</b> Reds VX	
<b>Wind:</b> 7.5	<b>Timing:</b> 20 degrees
<b>Pinion:</b>	<b>Spur:</b> 78t
<b>Battery:</b> LRP 2900 lcg	
<b>Battery Position:</b> full forward	

## Drivetrains:

<b>Transmission:</b>	<b>Laydown:</b> <input checked="" type="checkbox"/>
<b>3 Gear:</b> <input checked="" type="checkbox"/>	<b>Layback:</b> <input type="checkbox"/>
<b>4 Gear:</b> <input type="checkbox"/>	<b>Stand Up:</b> <input type="checkbox"/>
<b>Differential:</b>	<b>Ball Diff:</b> <input type="checkbox"/>
<b>Height:</b> 2	<b>Gear Diff:</b> <input checked="" type="checkbox"/>
<b>Notes:</b> 5k 4 gear	

## Slipper Clutches:

<b>Type:</b> Vented plates
<b># of Pads:</b> 2 x AS91197 LCF

## Shocks:

	Front	Rear
<b>Piston:</b>	2 x 1.6 (kit)	2 x 1.8 (kit)
<b>Fluid:</b>	450 cst	400 cst
<b>Spring:</b>	Red v2	Blue v2
<b>Limiters:</b>	2 x 0.30 inner (kit)	0
<b>Stroke:</b>	20mm	28mm
<b>Eyelet Length:</b>	long	long
<b>Cup Offset:</b>	0	0
<b>Notes:</b>		



## Track Info:

<b>Size:</b> Small <input checked="" type="checkbox"/> Medium <input type="checkbox"/> Large <input type="checkbox"/> Extra Large <input type="checkbox"/>
<b>Surface:</b> Dirt <input type="checkbox"/> Carpet <input checked="" type="checkbox"/> Astroturf <input type="checkbox"/> Multi Surface <input type="checkbox"/>
<b>Traction:</b> Low <input type="checkbox"/> Medium <input type="checkbox"/> High <input checked="" type="checkbox"/> Very High <input type="checkbox"/>
<b>Moisture:</b> Dry <input checked="" type="checkbox"/> Damp <input type="checkbox"/> Wet <input type="checkbox"/>
<b>Condition:</b> Indoor <input checked="" type="checkbox"/> Outdoor <input type="checkbox"/> Dusty <input type="checkbox"/> Hard Packed <input type="checkbox"/>
<b>Temperature:</b> Ambient: _____ Track: _____
<b>Notes:</b>

## Tires:

<b>Front Tires:</b> U6770 LP cut stagger
<b>Front Compound:</b> Yellow
<b>Front Insert:</b> None
<b>Rear Tires:</b> U6838 Cactus
<b>Rear Compound:</b> Yellow
<b>Rear Insert:</b> U6734 standard Schuey
<b>Wheel (F/R):</b> Schuey
<b>Notes:</b> outside and inside ribs off rear tyres

## Body, Wing, Weight:

<b>Body:</b> JC F2
<b>Wing:</b> Kyosho UM767
<b>Wing Angle:</b> 0° <input type="checkbox"/> 3° <input type="checkbox"/> 6° <input checked="" type="checkbox"/>
<b>Servo Weights:</b> None <input type="checkbox"/> Aluminum <input type="checkbox"/> Steel <input checked="" type="checkbox"/> Other <input type="checkbox"/>
<b>Electronic Weights:</b> None <input type="checkbox"/> Aluminum <input type="checkbox"/> Steel <input checked="" type="checkbox"/> Other <input type="checkbox"/>
<b>Total Vehicle Weight:</b> 1492g

## Vehicle Comments:

**Notes:** rear tyres were pretty shot but pace was still very good, final time was good enough for A5 at the meeting, Fred was unlucky in quali not getting a clean run otherwise the A final was well within reach